

ELEVATION CERTIFICATE

OMB No. 1660-0008
 Expiration Date: July 31, 2015

Important: Read the instructions on pages 1-9.

SECTION A - PROPERTY INFORMATION

FOR INSURANCE COMPANY USE
 Policy Number:
 Company NAIC Number:

A1. Building Owner's Name **JOSEPH C. AND ASHLEY ANN FIRRANTELLA**

A2. Building Street Address (including Apt., Unit, Suite, and/or Bldg. No.) or P.O. Route and Box No.
26 ARENTA STREET (GARAGE ONLY)
 City **ST. AUGUSTINE** State **FL** ZIP Code **32084**

A3. Property Description (Lot and Block Numbers, Tax Parcel Number, Legal Description, etc.) **TAX ID # 119830 0000**

A4. Building Use (e.g., Residential, Non-Residential, Addition, Accessory, etc.) RESIDENTIAL GARAGE

A5. Latitude/Longitude: Lat. 29°53'21.6" Long. 81°19'34.8" Horizontal Datum: NAD 1927 NAD 1983

A6. Attach at least 2 photographs of the building if the Certificate is being used to obtain flood insurance.

A7. Building Diagram Number 1A

A8. For a building with a crawlspace or enclosure(s):

- a) Square footage of crawlspace or enclosure(s) N/A sq ft
- b) Number of permanent flood openings in the crawlspace or enclosure(s) within 1.0 foot above adjacent grade N/A
- c) Total net area of flood openings in A8.b N/A sq in
- d) Engineered flood openings? Yes No

A9. For a building with an attached garage:

- a) Square footage of attached garage 480 sq ft
- b) Number of permanent flood openings in the attached garage within 1.0 foot above adjacent grade 3
- c) Total net area of flood openings in A9.b 323 sq in
- d) Engineered flood openings? Yes No

SECTION B - FLOOD INSURANCE RATE MAP (FIRM) INFORMATION

B1. NFIP Community Name & Community Number CITY OF ST. AUGUSTINE # 125145			B2. County Name ST. JOHNS		B3. State FLORIDA
B4. Map/Panel Number 12109C-0314	B5. Suffix H	B6. FIRM Index Date 07/18/2011	B7. FIRM Panel Effective/Revised Date 09/02/2004	B8. Flood Zone(s) AE	B9. Base Flood Elevation(s) (Zone AO, use base flood depth) 9

B10. Indicate the source of the Base Flood Elevation (BFE) data or base flood depth entered in Item B9.

- FIS Profile FIRM Community Determined Other/Source:

B11. Indicate elevation datum used for BFE in Item B9: NGVD 1929 NAVD 1988 Other/Source:

B12. Is the building located in a Coastal Barrier Resources System (CBRS) area or Otherwise Protected Area (OPA)? Yes No
 Designation Date: _____ CBRS OPA

SECTION C - BUILDING ELEVATION INFORMATION (SURVEY REQUIRED)

C1. Building elevations are based on: Construction Drawings* Building Under Construction* Finished Construction

*A new Elevation Certificate will be required when construction of the building is complete.

C2. Elevations - Zones A1-A30, AE, AH, A (with BFE), VE, V1-V30, V (with BFE), AR, AR/A, AR/AE, AR/AI-A30, AR/AH, AR/AO. Complete Items C2.a-h below according to the building diagram specified in Item A7. In Puerto Rico only, enter meters.

Benchmark Utilized: _____ Vertical Datum: NGVD 1929

Indicate elevation datum used for the elevations in items a) through h) below. NGVD 1929 NAVD 1988 Other/Source:

Datum used for building elevations must be the same as that used for the BFE.

Check the measurement used.

- | | | | |
|--|------------|--|---------------------------------|
| a) Top of bottom floor (including basement, crawlspace, or enclosure floor) | <u>7.5</u> | <input checked="" type="checkbox"/> feet | <input type="checkbox"/> meters |
| b) Top of the next higher floor | <u>N/A</u> | <input type="checkbox"/> feet | <input type="checkbox"/> meters |
| c) Bottom of the lowest horizontal structural member (V Zones only) | <u>N/A</u> | <input type="checkbox"/> feet | <input type="checkbox"/> meters |
| d) Attached garage (top of slab) | <u>N/A</u> | <input type="checkbox"/> feet | <input type="checkbox"/> meters |
| e) Lowest elevation of machinery or equipment servicing the building (Describe type of equipment and location in Comments) | <u>N/A</u> | <input type="checkbox"/> feet | <input type="checkbox"/> meters |
| f) Lowest adjacent (finished) grade next to building (LAG) | <u>6.5</u> | <input checked="" type="checkbox"/> feet | <input type="checkbox"/> meters |
| g) Highest adjacent (finished) grade next to building (HAG) | <u>7.2</u> | <input checked="" type="checkbox"/> feet | <input type="checkbox"/> meters |
| h) Lowest adjacent grade at lowest elevation of deck or stairs, including structural support | <u>N/A</u> | <input type="checkbox"/> feet | <input type="checkbox"/> meters |

SECTION D - SURVEYOR, ENGINEER, OR ARCHITECT CERTIFICATION

This certification is to be signed and sealed by a land surveyor, engineer, or architect authorized by law to certify elevation information. I certify that the information on this Certificate represents my best efforts to interpret the data available. I understand that any false statement may be punishable by fine or imprisonment under 18 U.S. Code, Section 1001.

- Check here if comments are provided on back of form.
 Check here if attachments.

Were latitude and longitude in Section A provided by a licensed land surveyor? Yes No

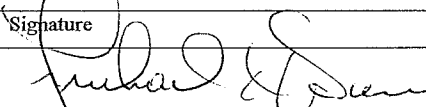
Certifier's Name MICHAEL A. PIESCO	License Number 4793
Title PLS	Company Name ANCIENT CITY SURVEYING
Address 4425 US 1 SOUTH, STE 401	City ST. AUGUSTINE State FL ZIP Code 32086
Signature 	Date 01/20/14 Telephone 904-797-9967

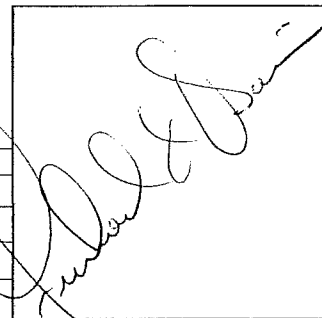

EVALUATION CERTIFICATE, page 2

IMPORTANT: In these spaces, copy the corresponding information from Section A.	FOR INSURANCE COMPANY USE
Building Street Address (including Apt., Unit, Suite, and/or Bldg. No.) or P.O. Route and Box No. 16 ARENA STREET	Policy Number:
City ST. AUGUSTINE State FL ZIP Code 32084	Company NAIC Number:

SECTION D – SURVEYOR, ENGINEER, OR ARCHITECT CERTIFICATION (CONTINUED)

Copy both sides of this Elevation Certificate for (1) community official, (2) insurance agent/company, and (3) building owner.

Comments

Signature _____ Date _____

SECTION E – BUILDING ELEVATION INFORMATION (SURVEY NOT REQUIRED) FOR ZONE AO AND ZONE A (WITHOUT BFE)

For Zones AO and A (without BFE), complete Items E1–E5. If the Certificate is intended to support a LOMA or LOMR-F request, complete Sections A, B, and C. For Items E1–E4, use natural grade, if available. Check the measurement used. In Puerto Rico only, enter meters.

- Provide elevation information for the following and check the appropriate boxes to show whether the elevation is above or below the highest adjacent grade (HAG) and the lowest adjacent grade (LAG).
 - Top of bottom floor (including basement, crawlspace, or enclosure) is _____ feet meters above or below the HAG.
 - Top of bottom floor (including basement, crawlspace, or enclosure) is _____ feet meters above or below the LAG.
- For Building Diagrams 6–9 with permanent flood openings provided in Section A Items 8 and/or 9 (see pages 8–9 of Instructions), the next higher floor (elevation C2.b in the diagrams) of the building is _____ feet meters above or below the HAG.
- Attached garage (top of slab) is _____ feet meters above or below the HAG.
- Top of platform of machinery and/or equipment servicing the building is _____ feet meters above or below the HAG.
- Zone AO only: If no flood depth number is available, is the top of the bottom floor elevated in accordance with the community’s floodplain management ordinance?
 Yes No Unknown. The local official must certify this information in Section G.

SECTION F – PROPERTY OWNER (OR OWNER’S REPRESENTATIVE) CERTIFICATION

The property owner or owner’s authorized representative who completes Sections A, B, and E for Zone A (without a FEMA-issued or community-issued BFE) or Zone AO must sign here. The statements in Sections A, B, and E are correct to the best of my knowledge.

Property Owner’s or Owner’s Authorized Representative’s Name _____

Address _____ City _____ State _____ ZIP Code _____

Signature _____ Date _____ Telephone _____

Comments

Check here if attachments.

SECTION G – COMMUNITY INFORMATION (OPTIONAL)

The local official who is authorized by law or ordinance to administer the community’s floodplain management ordinance can complete Sections A, B, C (or E), and G of this Elevation Certificate. Complete the applicable item(s) and sign below. Check the measurement used in Items G8–G10. In Puerto Rico only, enter meters.

- The information in Section C was taken from other documentation that has been signed and sealed by a licensed surveyor, engineer, or architect who is authorized by law to certify elevation information. (Indicate the source and date of the elevation data in the Comments area below.)
- A community official completed Section E for a building located in Zone A (without a FEMA-issued or community-issued BFE) or Zone AO.
- The following information (Items G4–G10) is provided for community floodplain management purposes.

G4. Permit Number	G5. Date Permit Issued	G6. Date Certificate Of Compliance/Occupancy Issued
-------------------	------------------------	---

- This permit has been issued for: New Construction Substantial Improvement
- Elevation of as-built lowest floor (including basement) of the building: _____ feet meters Datum
- BFE or (in Zone AO) depth of flooding at the building site: _____ feet meters Datum
- Community’s design flood elevation: _____ feet meters Datum

Local Official’s Name _____ Title _____

Community Name _____ Telephone _____

Signature _____ Date _____

Comments

Check here if attachments.

Building Photographs

See Instructions for Item A6.

IMPORTANT: In these spaces, copy the corresponding information from Section A.

FOR INSURANCE COMPANY USE

Building Street Address (including Apt., Unit, Suite, and/or Bldg. No.) or P.O. Route and Box No.
26 ARENTA STREET

Policy Number:

City ST. AUGUSTINE

State FL

ZIP Code 32084

Company NAIC Number:

If using the Elevation Certificate to obtain NFIP flood insurance, affix at least 2 building photographs below according to the instructions for Item A6. Identify all photographs with date taken; "Front View" and "Rear View"; and, if required, "Right Side View" and "Left Side View." When applicable, photographs must show the foundation with representative examples of the flood openings or vents, as indicated in Section A8. If submitting more photographs than will fit on this page, use the Continuation Page.

Date pictures taken: 16 JANUARY 2014



FRONT VIEW

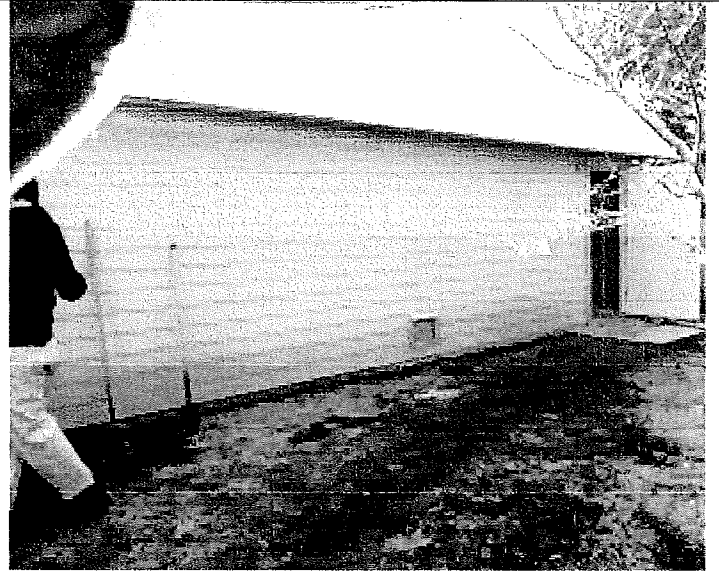

RIGHT VIEW

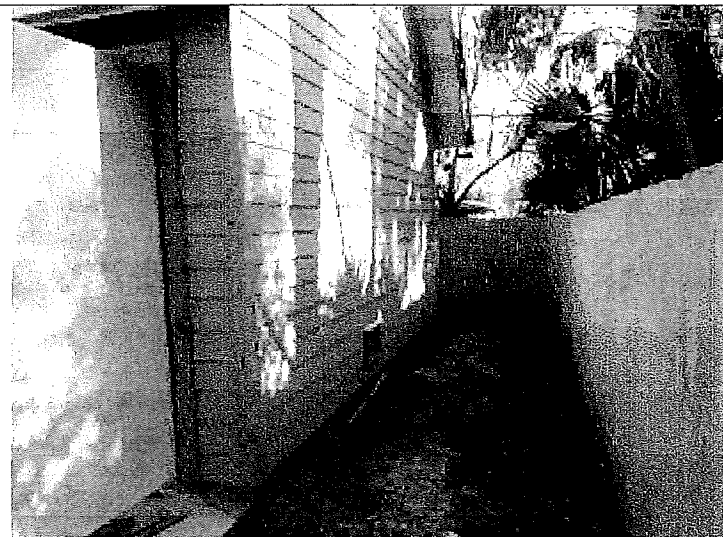

REAR VIEW

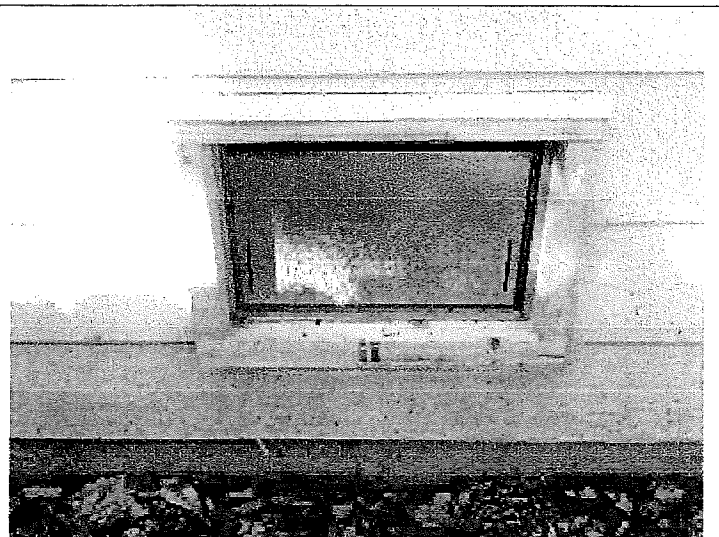

ENGINEERED VENT - TYPICAL